

# Marshmallow Tower

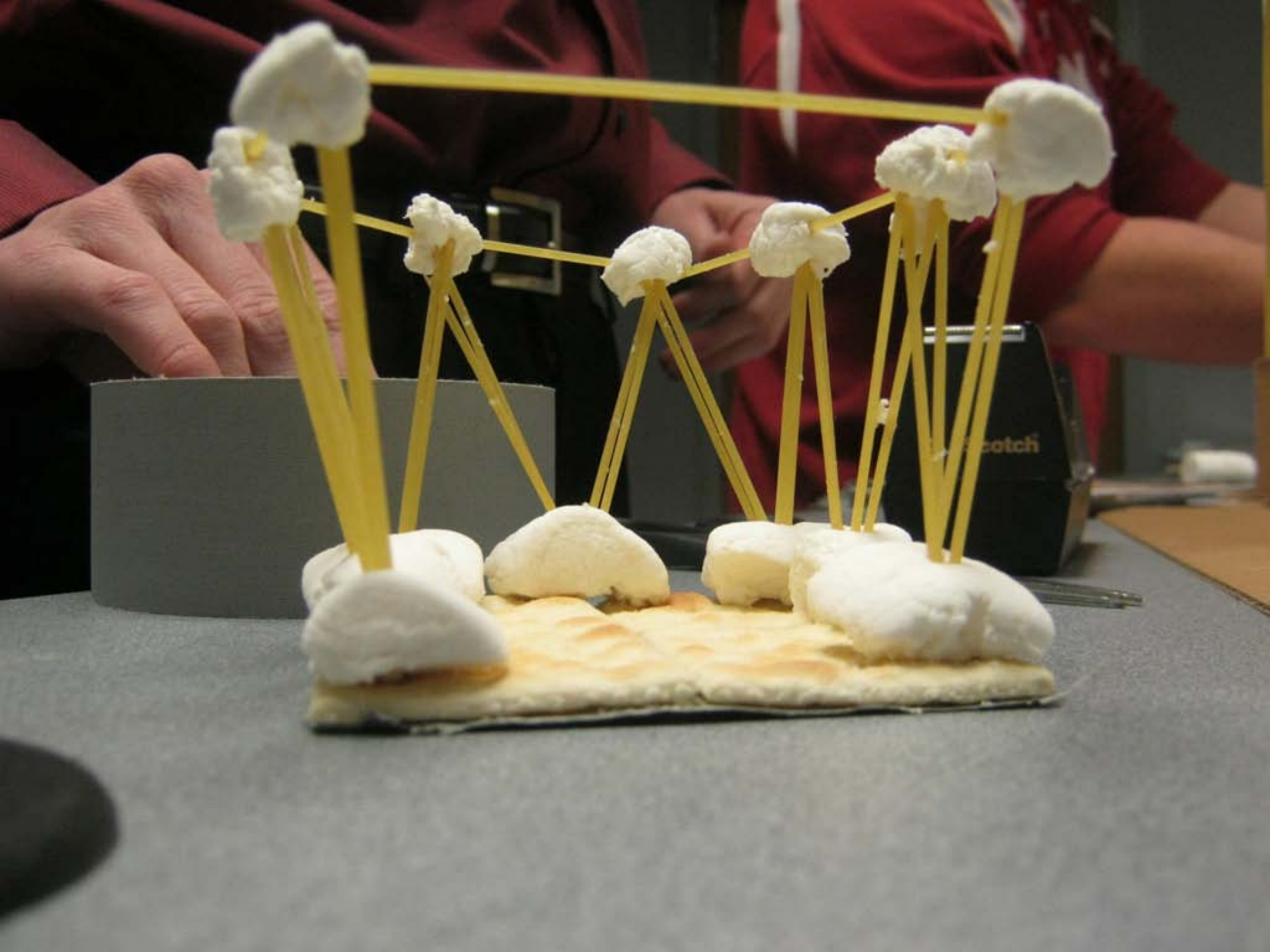





















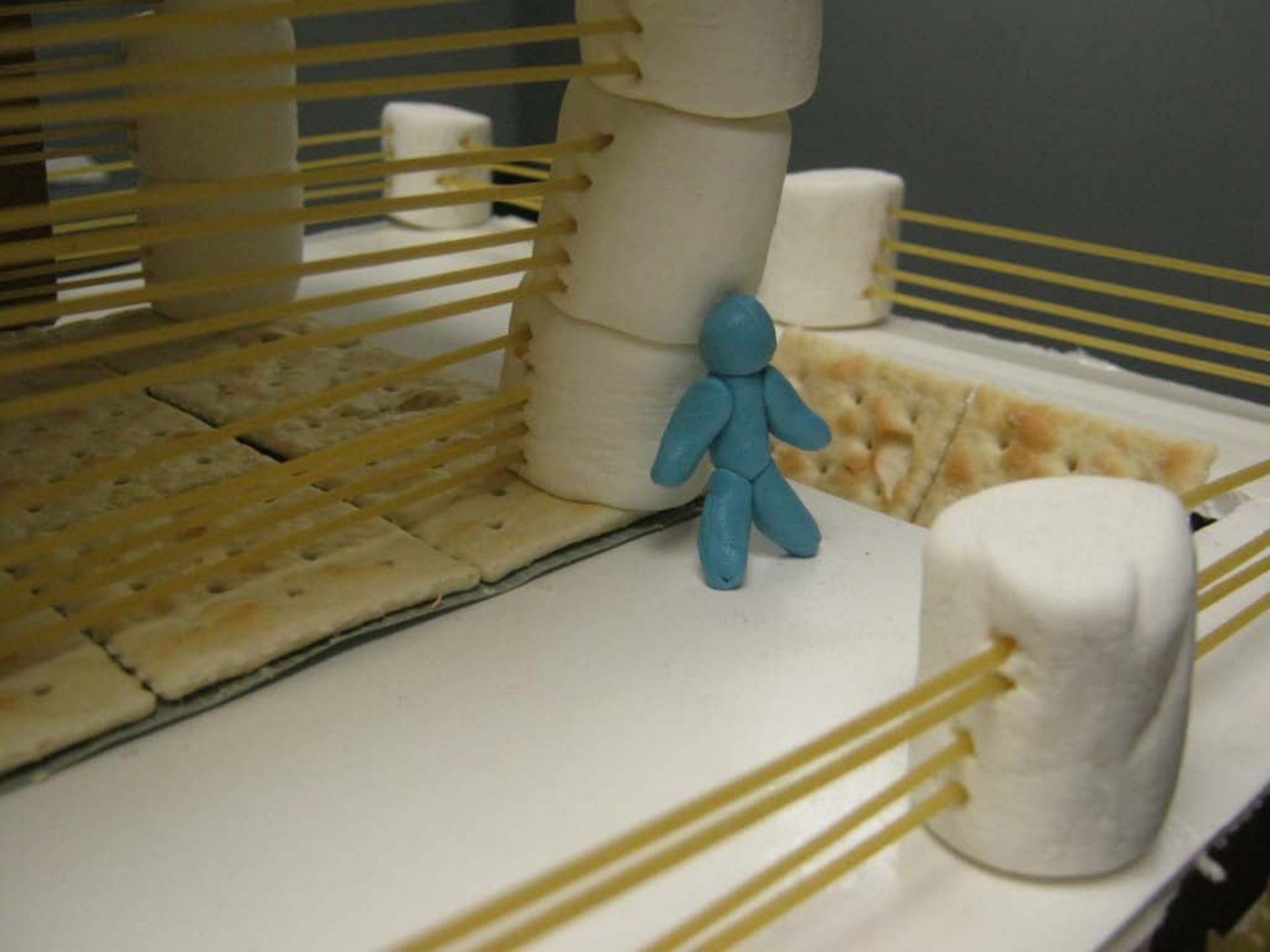





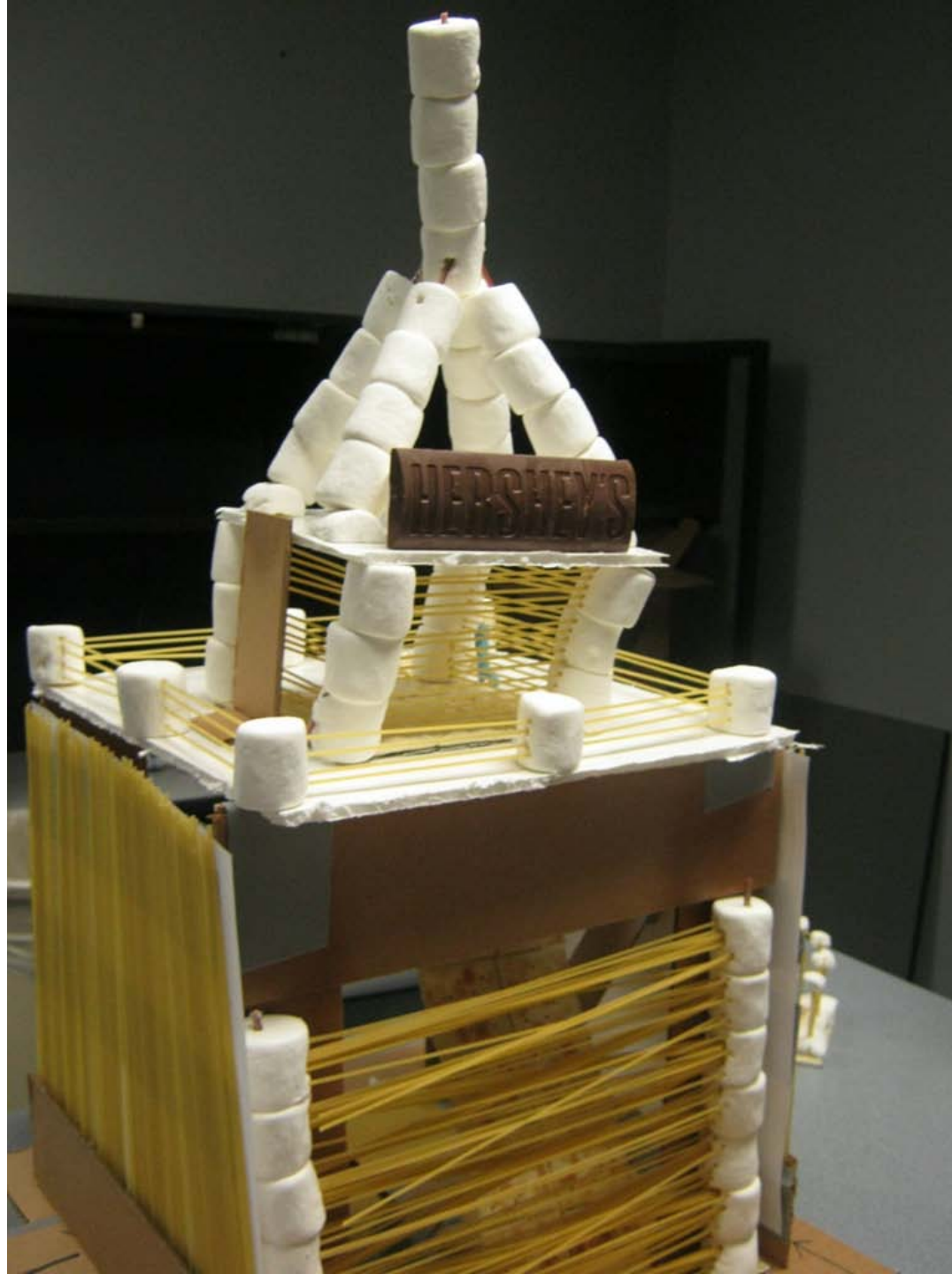















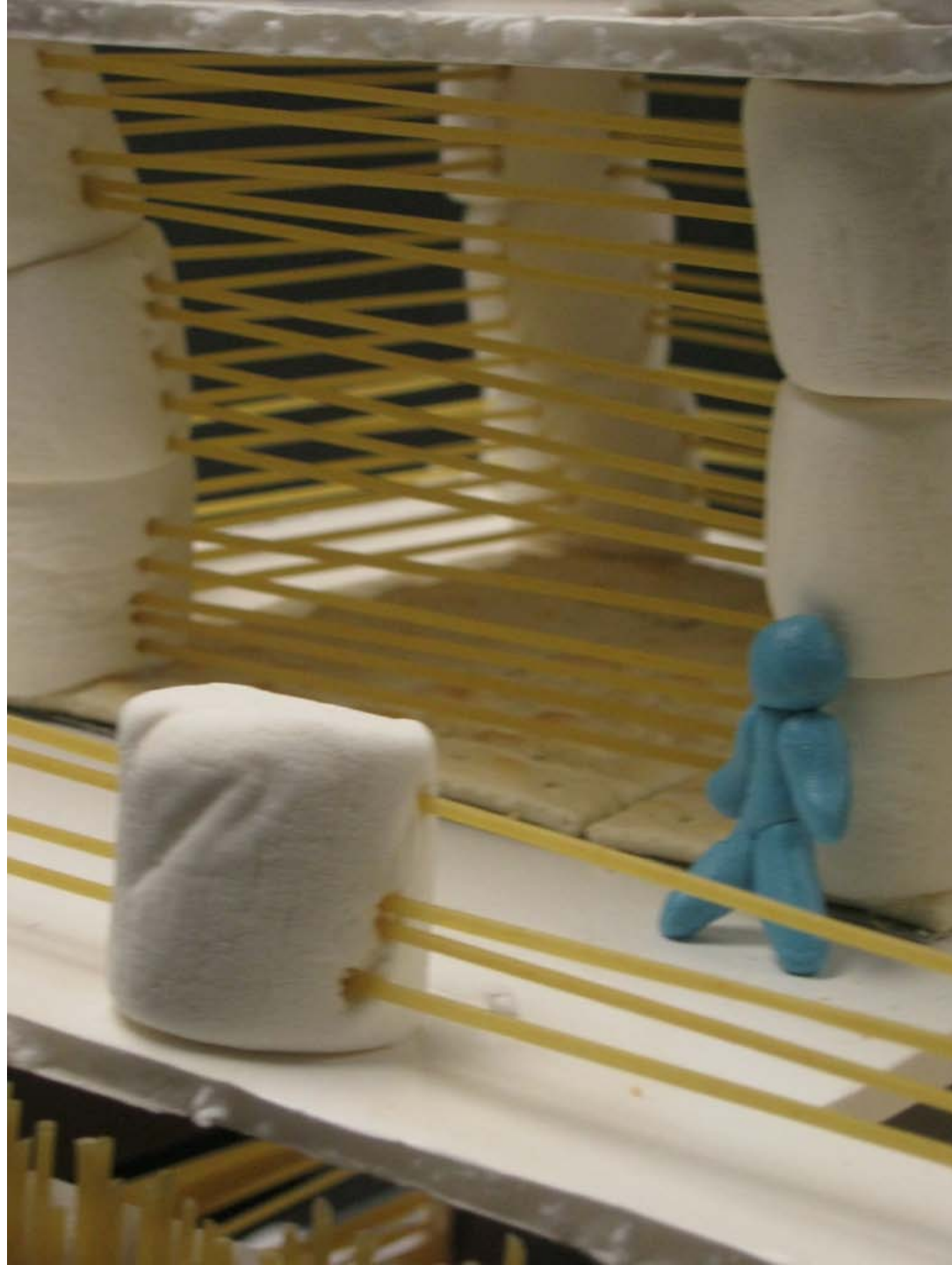

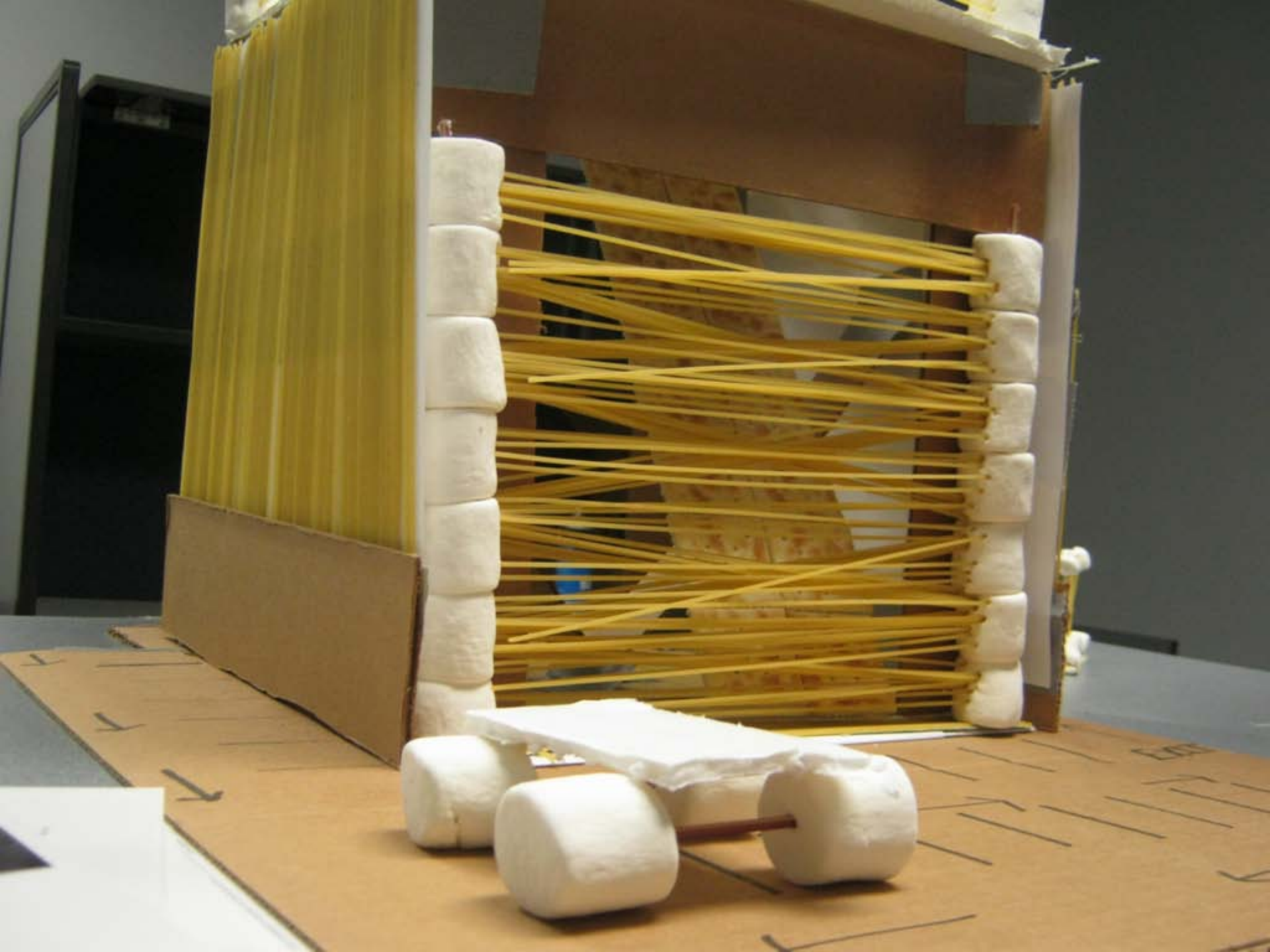





















CREATIVITY

T

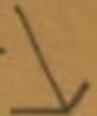
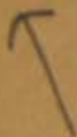

EXIT













## Timeline

9:45 - Walls floors done

10:15 - Digging Foundation

10:30 - Floors done

10:45 - Digging holes to  
raise model to 1st level

## TOP

### hari + Gabe

- ☒ Walls Gabe
- ☒ Floor hari
- ☒ Entryway for stairs hari
- ☒ Patio hari
- ☒ Fence for patio hari
- ☒ Ceiling for Café area Gabe
- ☒ Sign Gabe
- ☒ Tower Gabe

## Bottom

### Ashley + Josh

- ☒ Walls Josh
- ☒ Floor Ashley
- ☒ Stairs to Café Josh
- ☒ Patio Ashley
- ☒ Fence for patio Ashley
- ☒ Support Columns Ashley

Bottom









Ashley + Josh

- ☒ Walls Josh
- ☒ Floor Ashley
- ☒ Stairs to Café Josh
- ☒ Patio Ashley
- ☒ Fence for Patio Ashley
- ☒ Support Columns Ashley

TOP

re

## Khari + Gabe

-  Walls Gabe
-  Floor Khari
-  Entryway for stairs Khari
-  Patio Khari
-  Fence for patio Khari
-  Ceiling for Cafe area
-  Sign Gabe
-  Tower Gabe



# Timeline

9:45 - Walls + Floors done

10:15 - ~~Part 1's + fences done~~

10:30 - Floors assembled

10:45 - absolute latest to  
have model to Pin/Inston.



W

F

E

F

# Layout Design #2

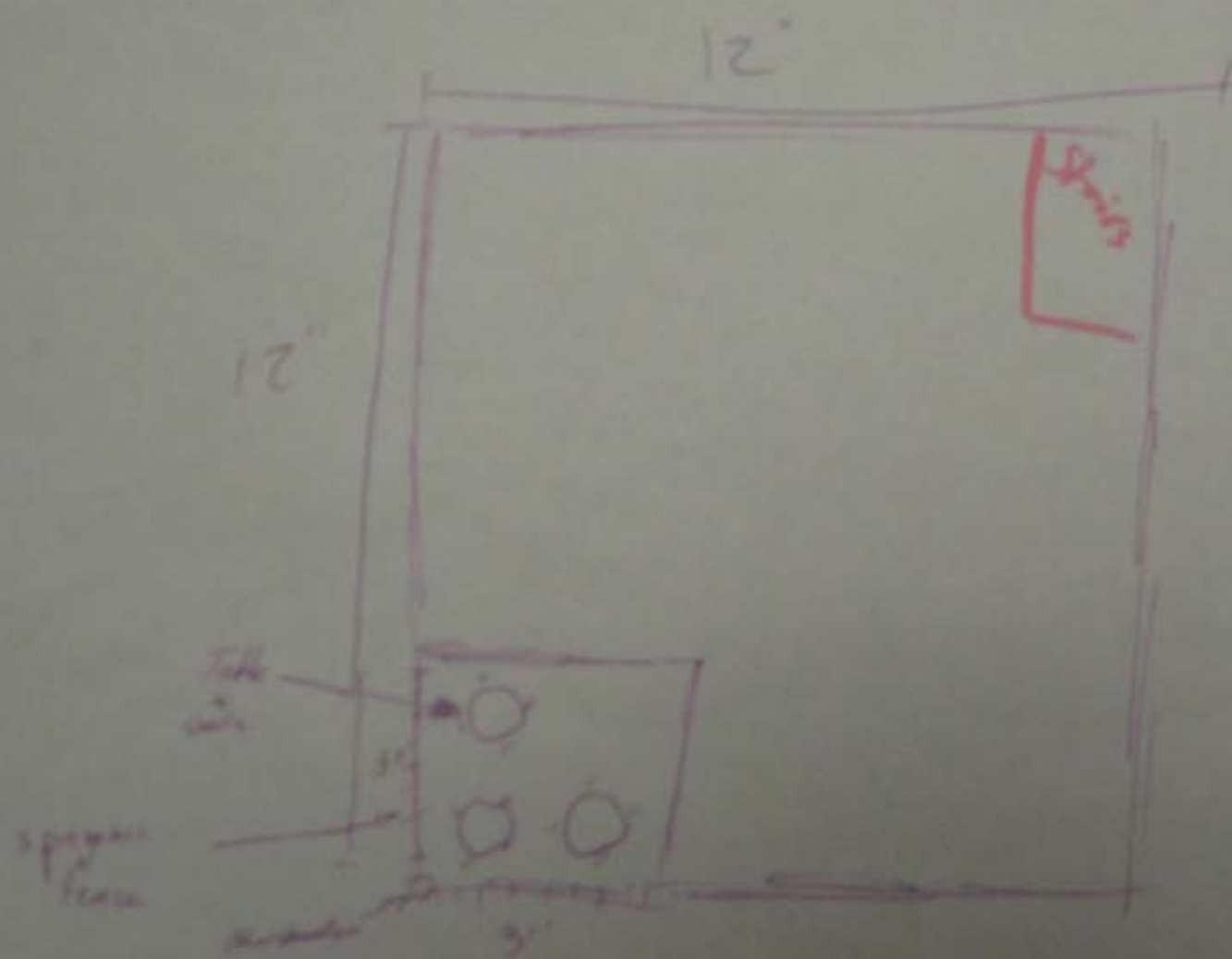

# Layout

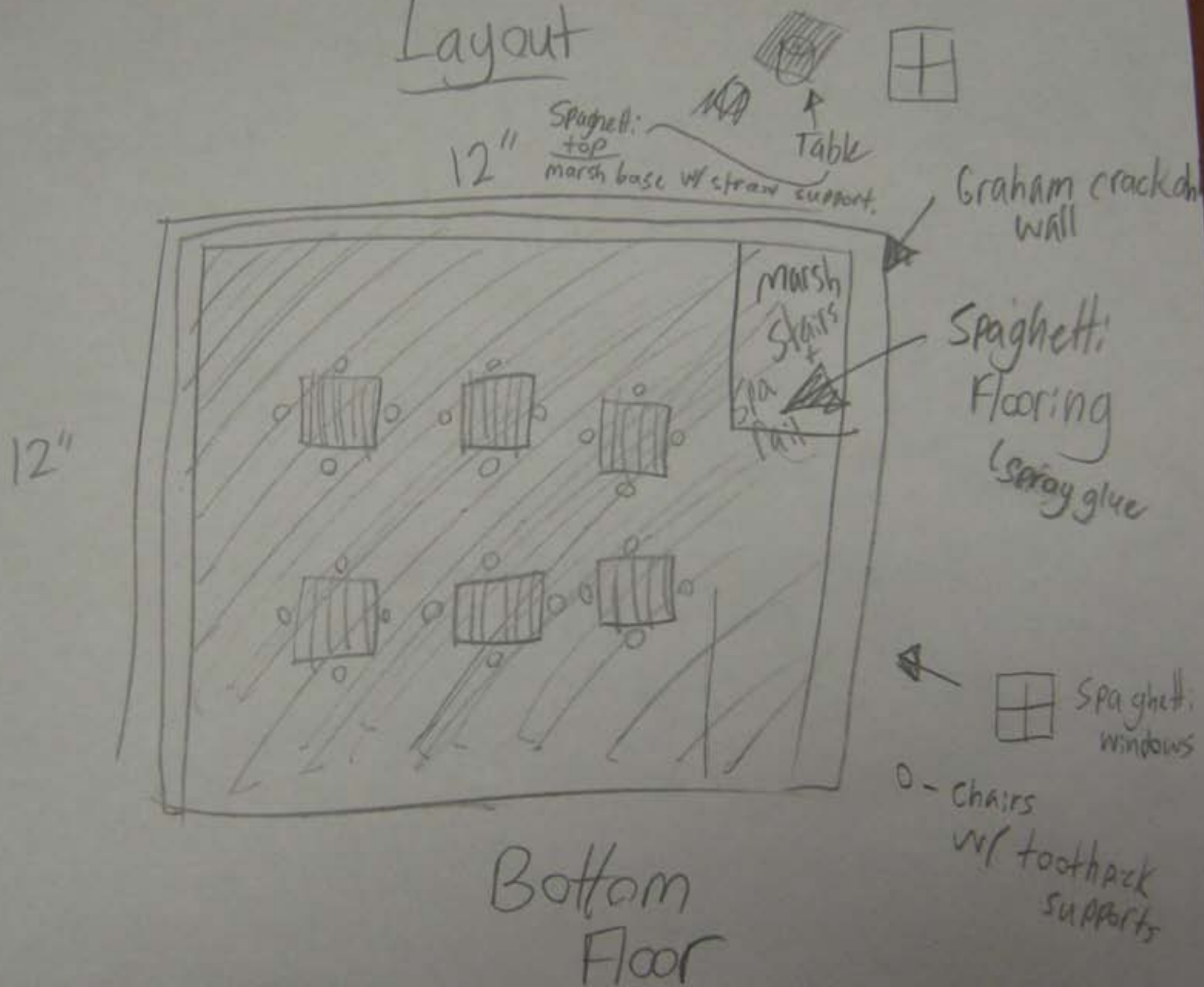



# Layout

